

Gordonton House

Gordonton, North Island, New Zealand

Frans Kamermans

Photography: Frans Kamermans

Gordonton House is a contemporary interpretation of the traditional New Zealand rural weatherboard vernacular. Designed on a pattern of 'barn-form' pavilions, which separate the components of the plan, this house makes full use of the generous 6701-square-metre site area. Traditionally detailed, the 378-square-metre house uses recyclable materials throughout, and incorporates both new and established methods for the control and use of solar energy. The house's sustainable features include—low-energy use achieved by appropriate set back of main glazing to allow winter sun access and summer sun shading; all day sun that opens up to the kitchen/dining/family room;

super insulation and double-glazing; and tiled concrete floor with underfloor heating to main living areas. Energy efficiency is further achieved through natural cross ventilation to the main living area, and solar-heated water with heat-pump backup (the pool acts as a 'dump' for surplus solar-heated water in summer, allowing for almost year-round solar-heated water).

The pool area and gardens are linked to the house through paved extensions of the main living area. They will, in time, become part of the whole as landscaping develops.



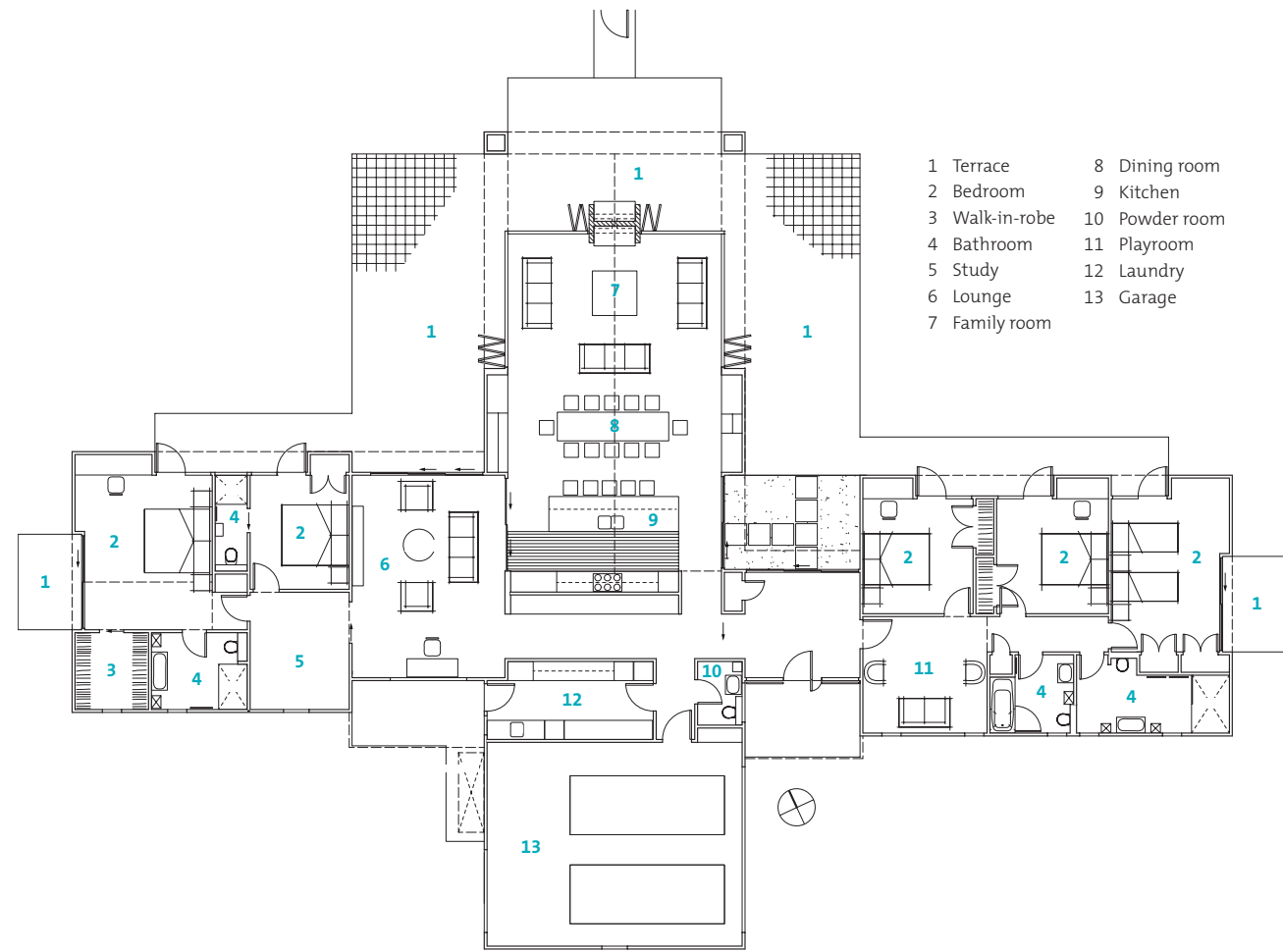

Ground floor

